

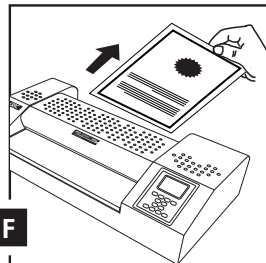

PRO SERIES™ 3600 / 4600
Pouch Laminators
Instruction Manual

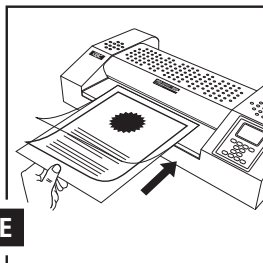

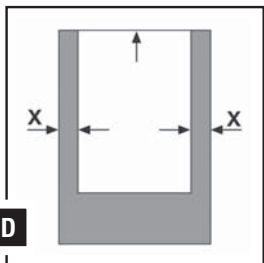
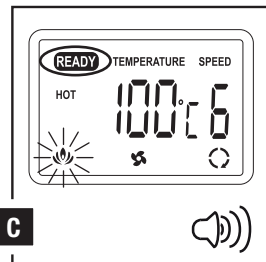
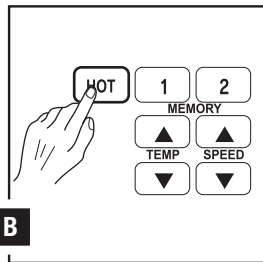
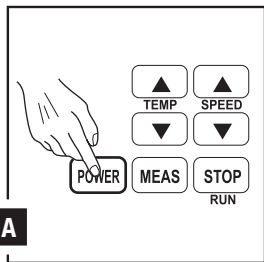
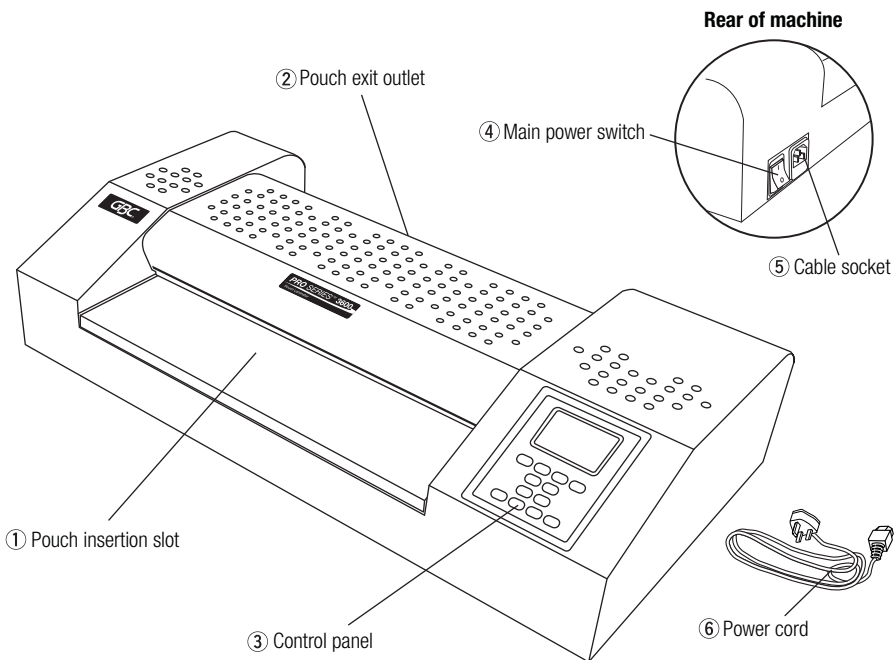
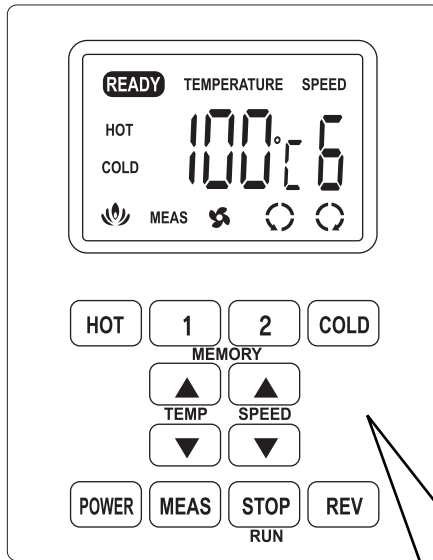

Display Panel

READY - Indicate that the machine is ready to laminate.

HOT - Indicate that the **HOT** function is selected.

COLD - Indicate that the **COLD** function is selected.

- Indicate that the heater is operating.

MEAS - Indicate that measure roller temperature function is selected.

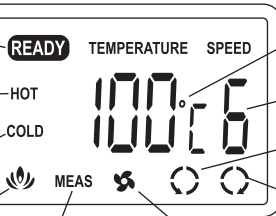

TEMPERATURE - Indicate the temperature setting.

SPEED - Indicate the speed setting.

- Indicate that the roller is moving in reverse revolution.

- Indicate that the roller is moving in forward revolution.

- Indicate that the cooling fan is operating.

Switch Panel

POWER - Power ON/OFF the machine.

HOT - Preset mode for hot lamination.

COLD - Preset mode for cold lamination.

MEAS - Display current roller temperature (approx. 3 seconds).

REV - Reverse the revolution of the rollers to correct misfeeds.

STOP - Stop/start the revolution of the rollers.

1 **2** - Memory mode for saving frequent use temperature and speed setting.

TEMP - These keys are used to increase or decrease temperature (0~140°C).

SPEED - These keys are used to adjust the speed (1~9) of the rollers. Speed 9 is the fastest speed.



Safety instructions



YOUR SAFETY AS WELL AS THE SAFETY OF OTHERS IS IMPORTANT TO ACCO BRANDS. IN THIS INSTRUCTION MANUAL ARE IMPORTANT SAFETY MESSAGES. READ THESE MESSAGES CAREFULLY.



THE SAFETY ALERT SYMBOL PRECEDES EACH SAFETY MESSAGE IN THIS INSTRUCTION MANUAL.

THIS SYMBOL INDICATES A POTENTIAL PERSONAL SAFETY HAZARD THAT COULD HURT YOU OR OTHERS, AS WELL AS CAUSE PRODUCT DAMAGE OR PROPERTY DAMAGE.

Special notice

Thank you, for your recent purchase of a GBC Pouch Laminator. Your new laminator may emit a slight odour during the initial stage of operation. It is normal and will diminish after several hours of operation.

Cleaning



Caution: Unplug this product before cleaning.

- Wipe exterior only with a damp cloth. Do not use detergents or solvents.
- Do not use aerosol dusters or cleaners.
- Do not spray anything into the machine.

Service

- Do not attempt to service or repair the pouch laminator yourself. Unplug the unit and contact an authorised ACCO Brands service representative for any required repairs.

Important safeguards



WARNING: FOR YOUR PROTECTION DO NOT CONNECT THE POUCH LAMINATOR TO ELECTRICAL POWER UNTIL YOU READ THESE INSTRUCTIONS COMPLETELY. KEEP THESE INSTRUCTIONS IN A CONVENIENT LOCATION FOR FUTURE REFERENCE. TO GUARD AGAINST INJURY, THE FOLLOWING BASIC SAFETY PRECAUTIONS MUST BE OBSERVED IN THE SET-UP AND USE OF THIS PRODUCT.

General safeguards

- Use the unit only for its intended purposes of laminating documents.
- Do not place anything in the throat opening of the laminator other than pouches/documents.
- Place unit on a secure, stable work area to prevent the unit from falling and possibly causing personal injury and damage to the unit.
- Follow all warnings and instructions marked on the unit.
- The socket outlet shall be installed near the equipment and shall be easily accessible.
- Do not attempt single side lamination, this will destroy the laminator.
- Do not block the vent slots, this will cause the laminator to overheat.

Electrical safeguards

- The unit must be connected to a supply voltage corresponding to the electrical rating shown on the unit.
- Unplug the unit before moving it, or when it is not in use for an extended period of time.
- Do not operate with a damaged supply cord or plug. Do not alter the attachment plug. The plug is configured for the appropriate electrical supply.
- Do not overload electrical outlets beyond their capacity; fire or electrical shock could result.
- The unit is intended for indoor use only.
- Close supervision is required when this product is used near children.

Technical specifications

	GBC PRO SERIES™ 3600	GBC PRO SERIES™ 4600
Electrical	220-240V / 50~60Hz / 1050W / 6.0A	220-240V / 50~60Hz / 1050W / 6.0A
Machine Dimensions	540 x 271 x 112 mm	691 x 271 x 112 mm
Machine Weight	15.0 kg	20.0 kg
Maximum Pouch Width	330 mm	480 mm
Maximum Pouch Thickness	2 x 350 mic (Total 700)	2 x 350 mic (Total 700)
Maximum Thru-put Thickness	3.0 mm	3.0 mm
Warm-Up Time	6 minutes	6 minutes

Operation, hot lamination

- 1 Connect power cord to appropriate power source.
- 2 Press the power switch on the back of the laminator and press the **POWER** button for 1 second to turn on the machine (fig. A).
- 3 Using the lamination guidelines, select the appropriate temperature setting for the pouch gauge thickness and material you are laminating.
 - If the laminated item appears to be cloudy, it means that the laminator temperature is not hot enough. Allow the laminator to heat for a few more minutes then run the pouch through again.
 - If the laminated item is wavy, the TEMPERATURE is too hot. Verify temperature selector is set at the appropriate temperature.
 - Always allow sufficient time for the laminator to adjust to changes in temperature setting.

1.Preset Mode

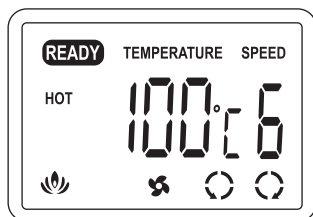

- a Press **HOT** button to choose Preset mode. Machine is set to temperature 100°C / speed 6 and "HOT" symbol appears on the LCD. (fig. B).

2.Manual Mode

(to change speed and temperature manually):

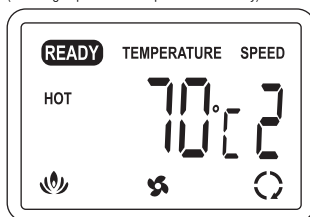

- a Press the temperature Up/Down arrow keys to modify the temperature setting.
- b Press the speed Up/Down arrow keys to modify the speed setting.

3.Memory Mode

(to save specific temperature and speed in memory):

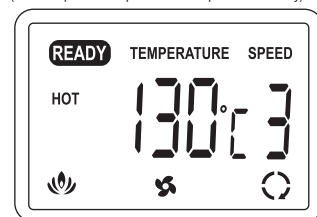

- a Press either button **1** or **2** for one second to enter memory mode.
- b Set your frequent use temperature and speed setting using the Up/Down arrow keys.
- c Press the number button again to save setting to memory.
- d To use a saved memory, select either button **1** or **2**. The LCD will indicate the temperature and speed selected.

- 4 As the machine warms up, the heating symbol () will flash. When the machine is ready to laminate, the laminator will beep and the "READY" symbol appears on the LCD (fig. C).
- 5 Centre the item to be laminated within the pouch left to right with the top edge against the sealed edge of the pouch (fig. D).
- 6 Insert the pouch with the sealed edge first into the machine (fig. E).
- 7 The laminated item will automatically exit the rear of the machine. After the pouch has stopped moving, immediately place it on a flat surface to cool for one minute before handling (fig. F).



Operation, cold lamination

- 1 Connect power cord to appropriate power source.
- 2 Press the power switch on the back of the laminator and press the **POWER** button for 1 second to turn on the machine.
- 3 Press **COLD** button and "COLD" symbol appears on the LCD.
- 4 When the machine is ready to laminate, the laminator will beep and the "READY" symbol appears on the LCD.
- 5 Use and laminate your cold pouch by pressing the **STOP <RUN>** button to start or stop the roller.

 **CAUTION:** If you have just done hot lamination, press **COLD** button (to cool down machine) and wait for the "READY" symbol to reappear on the LCD before attempting to do cold lamination.

Finishing lamination

- 1 Press and hold **POWER** button for one second and "COOL" symbol appears on the LCD.
- 2 After the roller cool down (below 65°C), the laminator will beep and power will be stopped automatically.
- 3 Press the power switch on the back of the laminator to turn the machine off.

 **CAUTION:** Cooling down the machine before turning off the power switch protects and extends the life of the rollers.

NOTE: For added safety and environmental reasons the laminator will automatically go into sleep mode after 120 minutes of inactivity. If you wish to use the laminator again, press the **POWER** button for 1 second to turn on the machine.

Reverse Button

In the event of a misfeed or a jam follow these instructions.

- 1 Press the **REV** button and hold down. This will reverse the rotation of the rollers allowing the pouch to exit the front of the machine.
- 2 Pull the document out of the laminator.
- 3 After the document is out of the machine clean the rollers by running the cleaning sheet through the laminator.

 **CAUTION:** Be careful when removing the laminated pouch from the machine. It may be hot.

Laminating Tips

- **DO NOT LAMINATE AN EMPTY POUCH.**
- Never insert the loose end of the pouch into the machine first. This could cause the machine to jam.
- Before laminating important or unique documents, always run a test pouch through the laminator using a similar type of document.
- As soon as hot lamination is completed, remove the lamination from the front of the machine and place on a cool flat surface for cooling to prevent the pouch from curling.
- Do not cut pouches prior to lamination.

Guarantee

ACCO Brands (ACCO) warrants its products and their parts against defects in materials and workmanship under normal use for a period of 12 months from the original date of purchase. During this period, ACCO will, at its discretion, in accordance with law, either repair the machine using new or refurbished parts, or replace the machine with a new or refurbished machine that is equivalent to the machine being replaced. The warranty applies only to defects in materials and workmanship under normal use and does not extend to damage to the product or parts which result from:-

- alteration, repair, modification or service carried out by anyone other than an authorised ACCO service centre.
- accident, neglect, abuse or misuse owing to failure to comply with the normal operating procedures of the product.

Lamination Guide

Material	Film thickness	Setting without Carrier		Setting with Carrier	
		Temperature	Speed	Temperature	Speed
Copy Paper	75 ~ 100 Micron	100°C	6	130°C	4
	125 ~ 150 Micron	120°C	4	130°C	3
	175 ~ 250 Micron	120°C	3	140°C	2
	300 ~ 350 Micron	130°C	2	-	-
Brochure Paper	75 ~ 100 Micron	100°C	5	130°C	4
	125 ~ 150 Micron	120°C	3	140°C	3
	175 ~ 250 Micron	130°C	2	140°C	2
	300 ~ 350 Micron	140°C	2	-	-
Photo Paper	75 ~ 100 Micron	100°C	4	130°C	3
	125 ~ 150 Micron	130°C	3	140°C	2
	175 ~ 250 Micron	140°C	2	140°C	1

NOTE: For “STAND BY” mode, please keep the temperature at 70°C and speed 2.

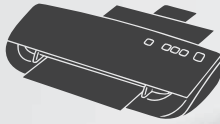

GBC Laminating / Plastifieuses / Laminiergeräte



Rxel Shredding / Destructeurs / Aktenvernichter



GBC Binding / Perforelieuses / Bindegeräte

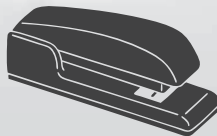

Rxel Stapling / Agrafage / Heftgeräte